

# DATA SHEET



## Three Phase Induction Motor - Squirrel Cage

Customer : GeTech Automation SRL

Product line : W22 IE3 Three-Phase Product code : 12885654

Frame	: 200L	Locked rotor time	: 16s (cold) 9s (hot)
Output	: 30 kW (40 HP)	Temperature rise	: 80 K
Poles	: 4	Duty cycle	: S1
Frequency	: 50 Hz	Ambient temperature	: -20°C to +40°C
Rated voltage	: 400/690 V	Altitude	: 1000 m.a.s.l.
Rated current	: 57.1/33.1 A	Protection degree	: IP55
L. R. Amperes	: 428/248 A	Cooling method	: IC411 - TEFC
LRC	: 7.5	Mounting	: B35T
No load current	: 27.0/15.7 A	Rotation <sup>1</sup>	: Both (CW and CCW)
Rated speed	: 1480 rpm	Noise level <sup>2</sup>	: 63.0 dB(A)
Slip	: 1.33 %	Starting method	: Direct On Line
Rated torque	: 194 Nm	Approx. weight <sup>3</sup>	: 274 kg
Locked rotor torque	: 280 %		
Breakdown torque	: 310 %		
Insulation class	: F		
Service factor	: 1.00		
Moment of inertia (J)	: 0.3202 kgm <sup>2</sup>		
Design	: N		

Output	50%	75%	100%	Foundation loads	
Efficiency (%)	92.9	93.6	93.6	Max. traction	: 5727 N
Power Factor	0.63	0.75	0.81	Max. compression	: 8411 N

Losses at normative operating points (speed;torque), in percentage of rated output power

P1 (0,9;1,0)	P2 (0,5;1,0)	P3 (0,25;1,0)	P4 (0,9;0,5)	P5 (0,5;0,5)	P6 (0,5;0,25)	P7 (0,25;0,25)
6.6	5.8	5.4	3.1	2.3	1.5	1.1

		<u>Drive end</u>	<u>Non drive end</u>
Bearing type	:	6312	6212 ZZ C3
Sealing	:	Oil Seal	Lip Seal
Lubrication interval	:	20000 h	40000 h
Lubricant amount	:	21 g	0 g
Lubricant type	:	Mobil Polyrex EM	

Notes

This revision replaces and cancel the previous one, which must be eliminated.

- (1) Looking the motor from the shaft end.
- (2) Measured at 1m and with tolerance of +3dB(A).
- (3) Approximate weight subject to changes after manufacturing process.
- (4) At 100% of full load.

These are average values based on tests with sinusoidal power supply, subject to the tolerances stipulated in IEC 60034-1.

Rev.	Changes Summary	Performed	Checked	Date
Performed by		Page 1 / 6		Revision
Checked by				
Date	31/01/2025			

# DATA SHEET



## Three Phase Induction Motor - Squirrel Cage

Customer : GeTech Automation SRL

### Thermal protection

ID	Application	Type	Quantity	Sensing Temperature
1	Winding	Thermistor - 2 wires	1 x Phase	155 °C

Rev.	Changes Summary	Performed	Checked	Date
Performed by				
Checked by			Page	Revision
Date	31/01/2025		2 / 6	

# TORQUE AND CURRENT VS SPEED CURVE



## Three Phase Induction Motor - Squirrel Cage

Customer : GeTech Automation SRL

Product line : W22 IE3 Three-Phase

Product code : 12885654

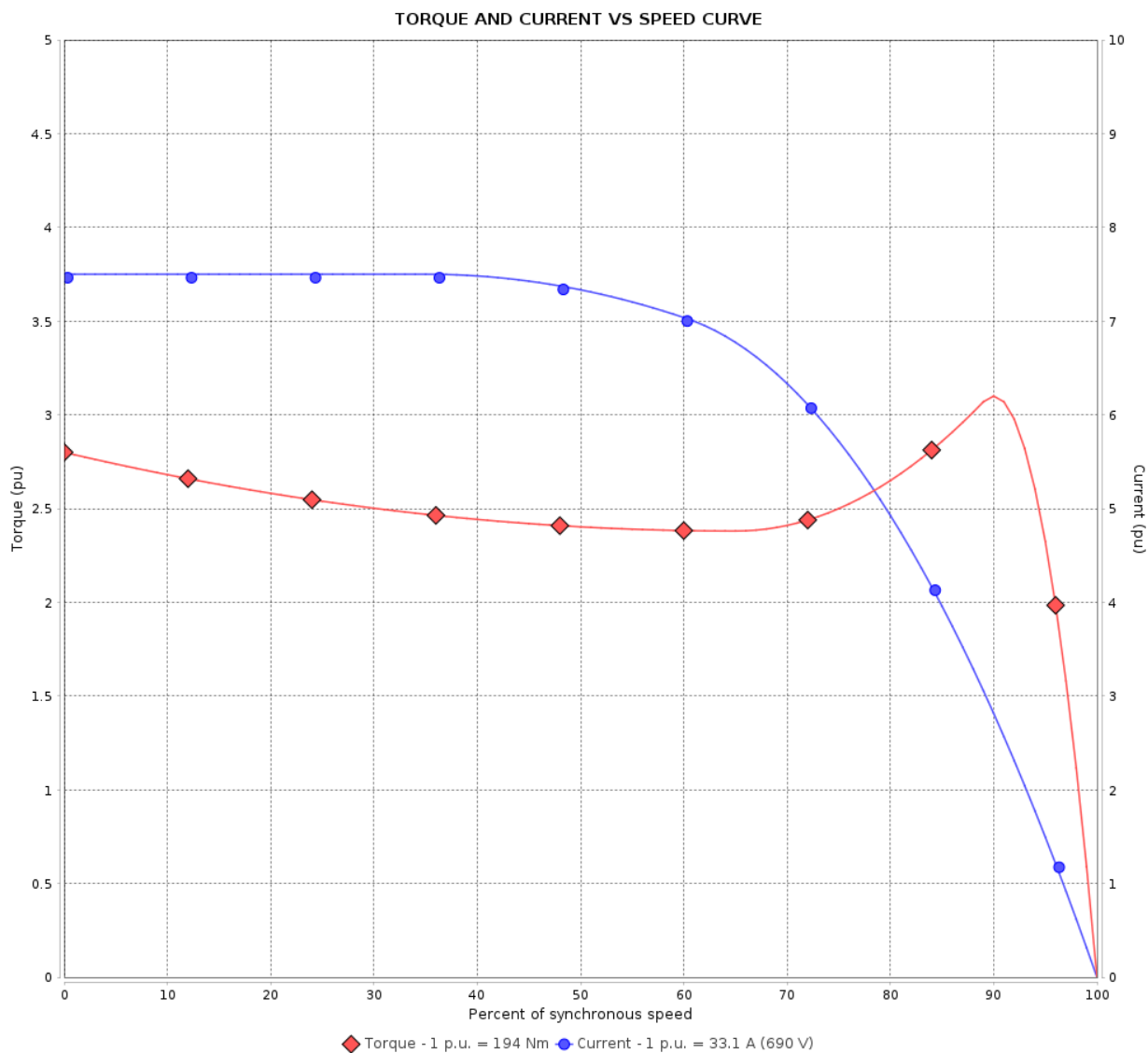

Performance : 400/690 V 50 Hz 4P

Rated current	: 57.1/33.1 A	Moment of inertia (J)	: 0.3202 kgm <sup>2</sup>
LRC	: 7.5	Duty cycle	: S1
Rated torque	: 194 Nm	Insulation class	: F
Locked rotor torque	: 280 %	Service factor	: 1.00
Breakdown torque	: 310 %	Temperature rise	: 80 K
Rated speed	: 1480 rpm	Design	: N

Locked rotor time : 16s (cold) 9s (hot)

Rev.	Changes Summary	Performed	Checked	Date
Performed by			Page 3 / 6	Revision
Checked by				
Date	31/01/2025			

# LOAD PERFORMANCE CURVE

Three Phase Induction Motor - Squirrel Cage



Customer : GeTech Automation SRL

Product line : W22 IE3 Three-Phase

Product code :

12885654

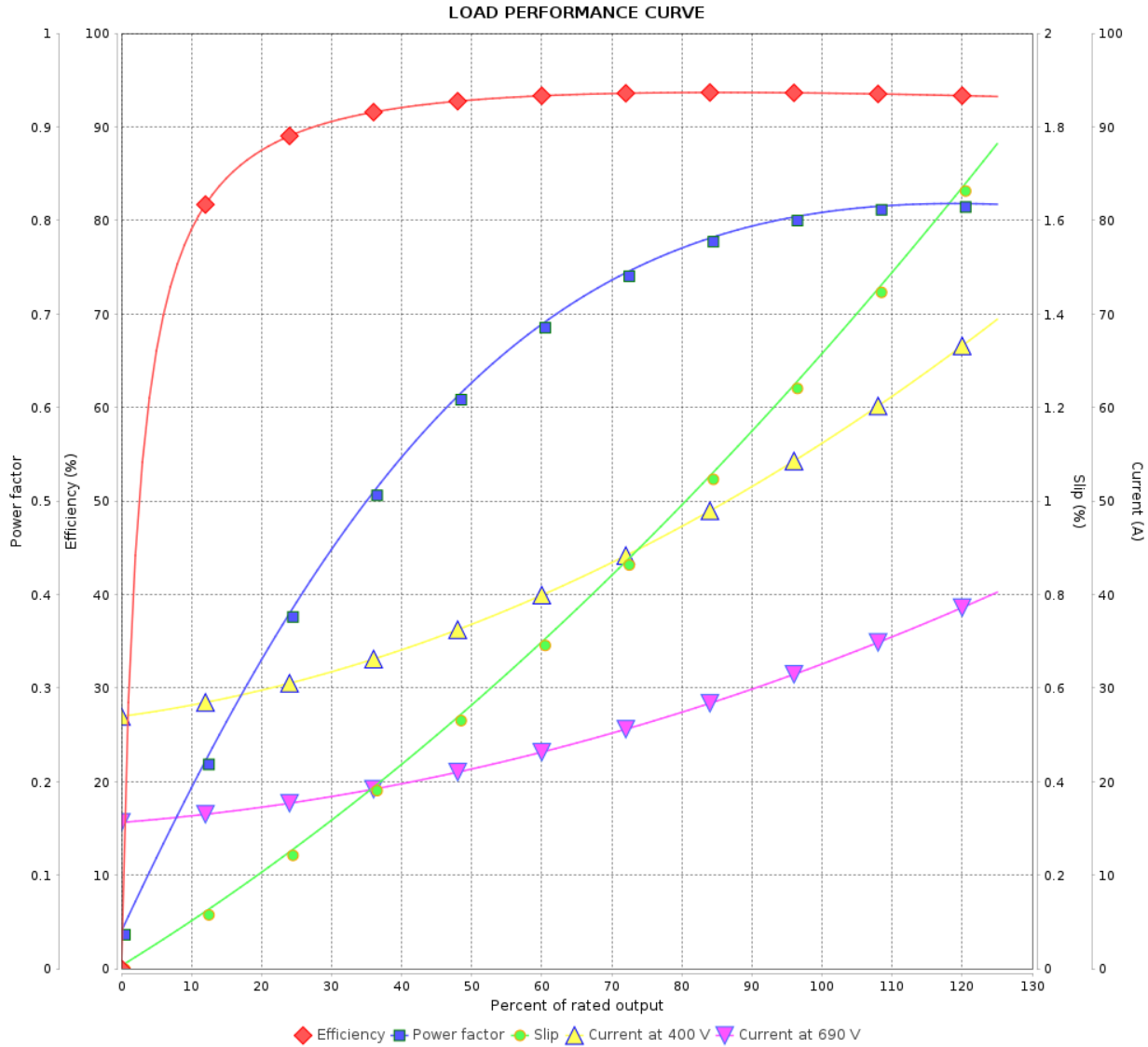

Performance : 400/690 V 50 Hz 4P

Rated current : 57.1/33.1 A  
 LRC : 7.5  
 Rated torque : 194 Nm  
 Locked rotor torque : 280 %  
 Breakdown torque : 310 %  
 Rated speed : 1480 rpm

Moment of inertia (J) : 0.3202 kgm<sup>2</sup>  
 Duty cycle : S1  
 Insulation class : F  
 Service factor : 1.00  
 Temperature rise : 80 K  
 Design : N

Rev.	Changes Summary	Performed	Checked	Date
Performed by			Page 4 / 6	Revision
Checked by				
Date	31/01/2025			

# THERMAL LIMIT CURVE

## Three Phase Induction Motor - Squirrel Cage



Customer : GeTech Automation SRL

Product line : W22 IE3 Three-Phase

Product code :

12885654

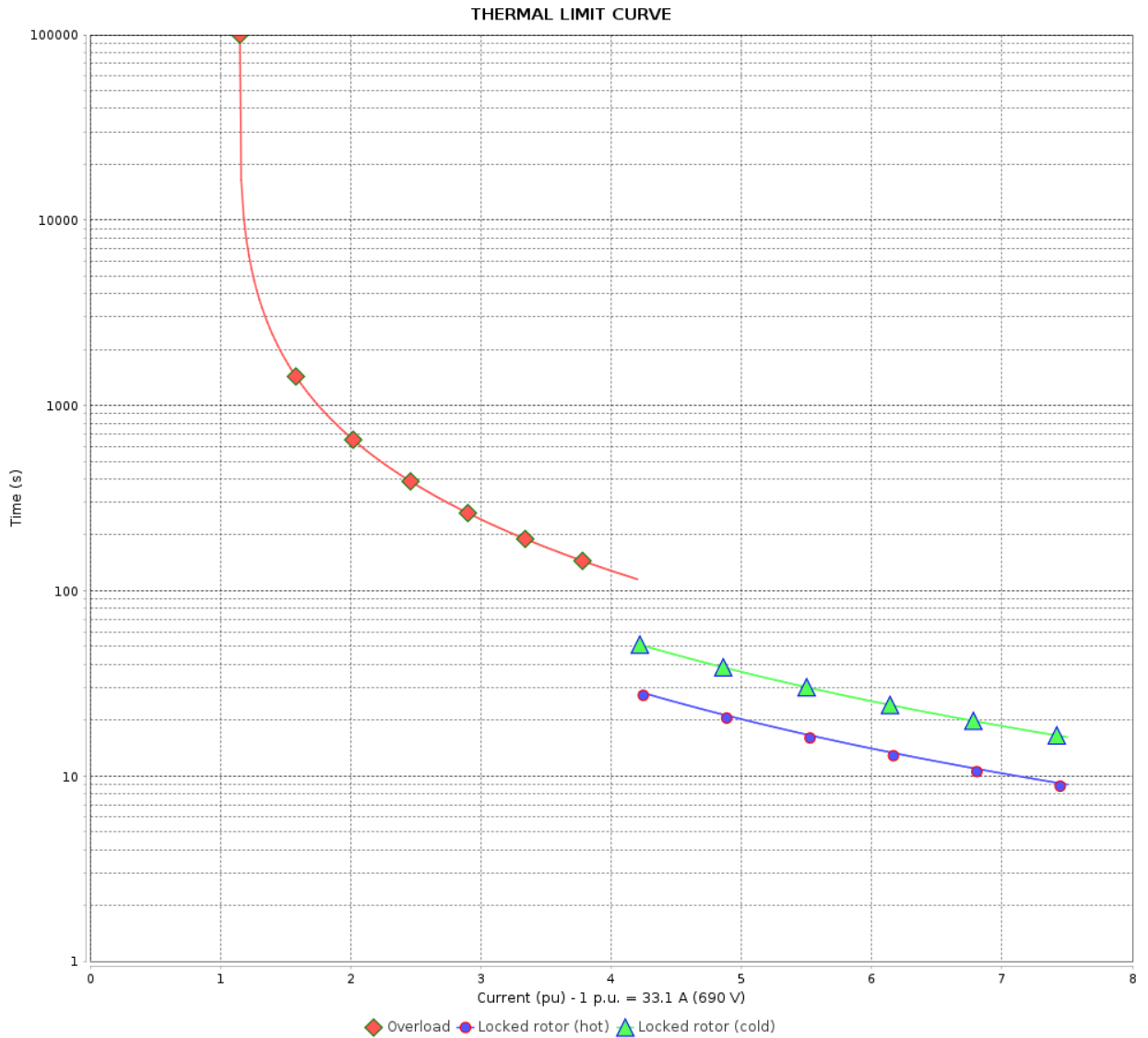

Performance : 400/690 V 50 Hz 4P

Rated current : 57.1/33.1 A  
 LRC : 7.5  
 Rated torque : 194 Nm  
 Locked rotor torque : 280 %  
 Breakdown torque : 310 %  
 Rated speed : 1480 rpm

Moment of inertia (J) : 0.3202 kgm<sup>2</sup>  
 Duty cycle : S1  
 Insulation class : F  
 Service factor : 1.00  
 Temperature rise : 80 K  
 Design : N

Heating constant

Cooling constant

Rev.	Changes Summary	Performed	Checked	Date
Performed by				
Checked by				
Date				
		5 / 6		

# VFD OPERATION CURVE

Three Phase Induction Motor - Squirrel Cage



Customer : GeTech Automation SRL

Product line : W22 IE3 Three-Phase

Product code : 12885654

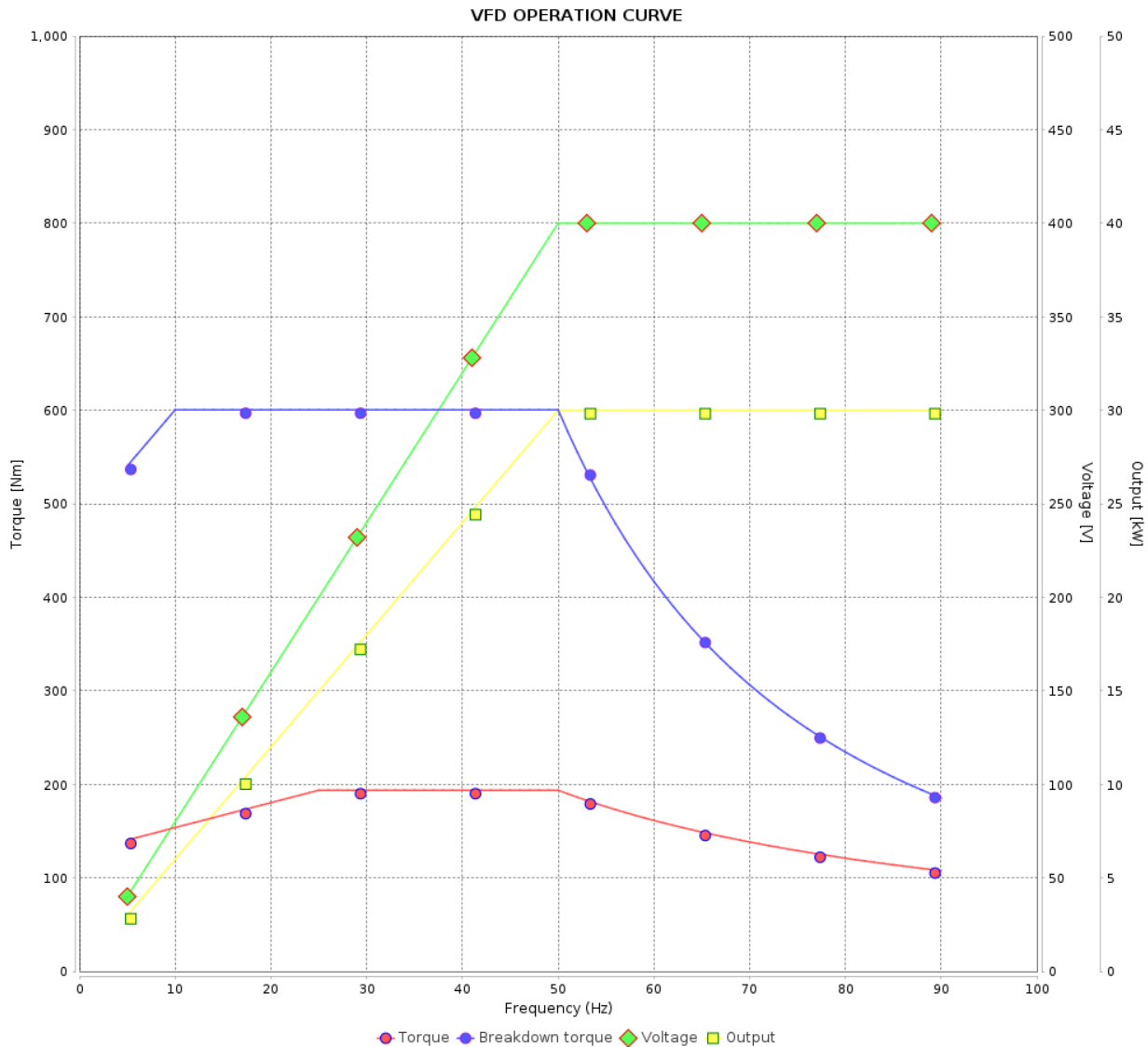

Performance : 400/690 V 50 Hz 4P

Rated current : 57.1/33.1 A  
 LRC : 7.5  
 Rated torque : 194 Nm  
 Locked rotor torque : 280 %  
 Breakdown torque : 310 %  
 Rated speed : 1480 rpm

Moment of inertia (J) : 0.3202 kgm<sup>2</sup>  
 Duty cycle : S1  
 Insulation class : F  
 Service factor : 1.00  
 Temperature rise : 80 K  
 Design : N

Rev.	Changes Summary	Performed	Checked	Date
Performed by			Page 6 / 6	Revision
Checked by				
Date	31/01/2025			

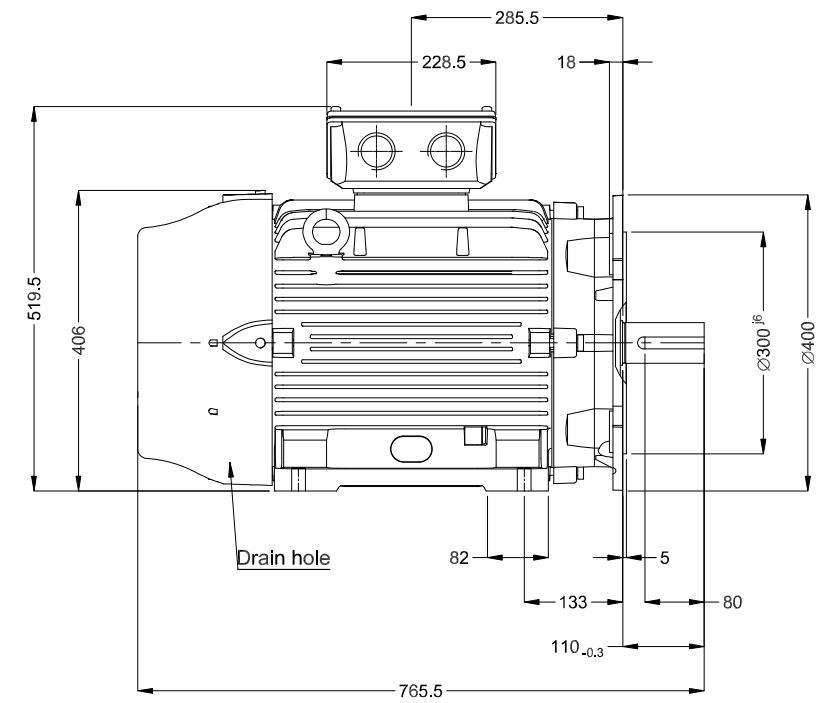
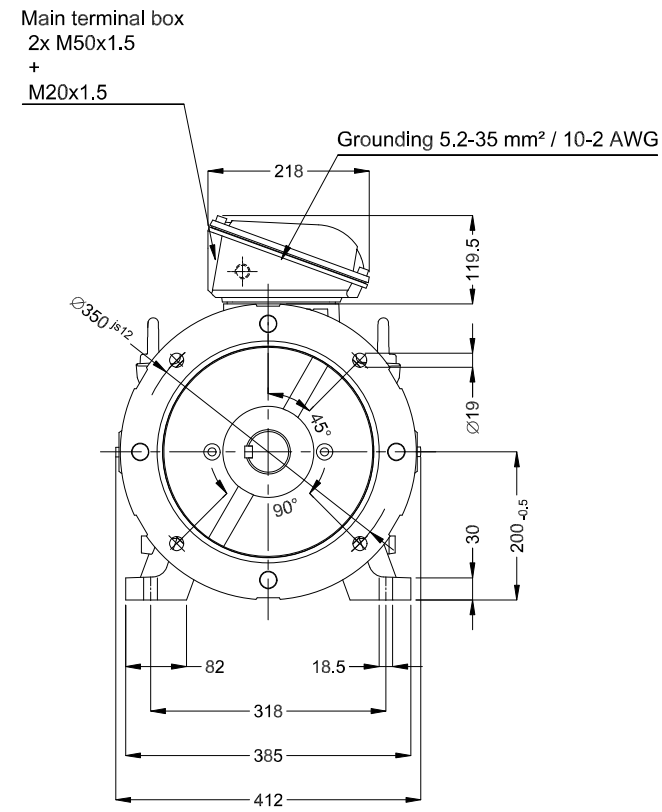
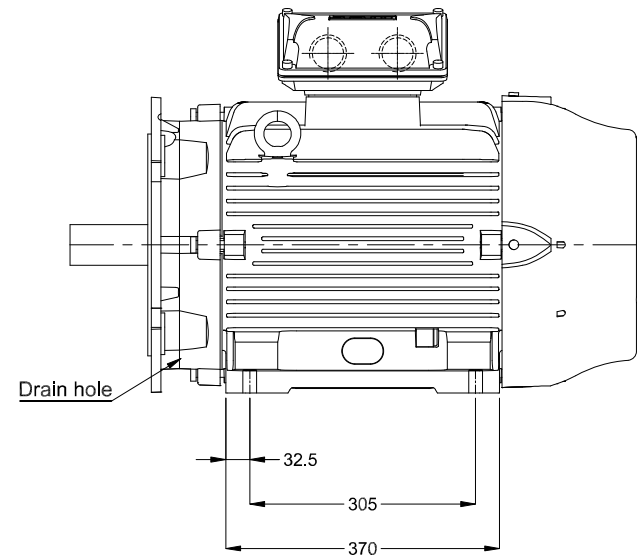

Sealing - oil seal ring  
 Without vertical jackscrews  
 Color RAL 5009  
 Painting plan 203A  
 Mounting B35T

DE Shaft End

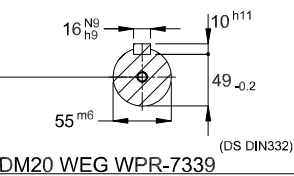

30 kW 04 Poles 50 Hz

A

Scale 1 : 10

ECM	LOC	SUMMARY OF MODIFICATIONS	EXECUTED	CHECKED	RELEASED	DATE	VER
EXECUTED	HYBRISUSER	THREE PH. MOTOR W22 IE3					
CHECKED		FRAME 200L IP55 TEFC					
RELEASED							
REL. DATE							

HYBRISUSER						00	
EXECUTED		CHECKED		RELEASED		DATE	
EXECUTED		CHECKED		RELEASED		DATE	
EXECUTED		CHECKED		RELEASED		DATE	
EXECUTED		CHECKED		RELEASED		DATE	

PREVIEW

WDD 00

SHEET 1 / 1

